

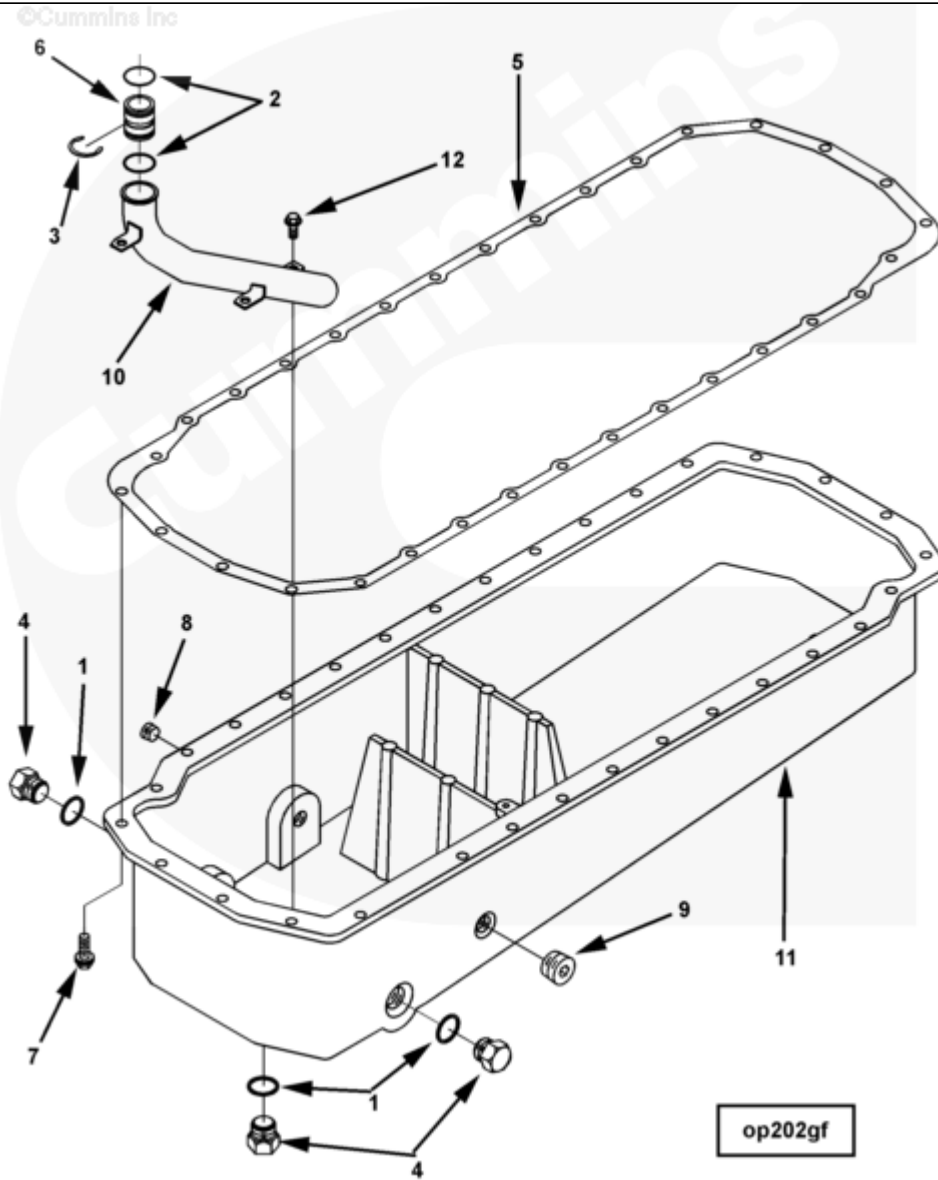

Parts Catalog - Option Detail

Electronic Parts Catalog - Option Detail				
Option	Group	Graphic	Film Card	Date
OP2120-02	07.01	op202gf	II	25-APR-05
Engines	ISM CM570, ISM CM570/870, ISM CM875, ISM CM876, ISM CM876 E, ISM11 CM876 M103, ISM11 CM876 SN, M11 CELECT, M11 CELECT PLUS, M11 MECHANICAL, QSM11 CM570, QSM11 CM876			



[SMALL](#) | [MEDIUM](#) | [LARGE](#)

Cart	Ref No	Part Number	Part Description	Required	Remarks
View My Cart					
		OP2120-02	Oil Pan		

					Oil Pan
					Sump Location: Front
					Material: Cast Aluminum
					High Oil Pan Capacity:
					30.28 L (8.0 Gal)
					Low Oil Pan Capacity: 26.5 L
					(7.0 Gal)
					Angularity Limits:
					15 Degrees Front Down
					31 Degrees Rear Down
					37 Degrees Fuel Pump Down
					45 Degrees Exhaust Down
					Drain Loc (1"-18 UNS): Bottom
					And Both Sides
					Lube Oil Suction Tube:
					Oil Pan Mounted
					Noise Panel Provision: No
					Oil Heater Boss (1" NPTF):
					Left Side
					Oil Temperature Boss (1/2"
					NPTF): Right Side
					Low Oil Level Sensor Boss
					(3/8" NPTF): None
					Rust Inhibitor Required: No
<input type="checkbox"/>	1	67946	Plain Washer	1	1 1/32 in.
<input type="checkbox"/>	2	3032787	O-Ring Seal	2	
<input type="checkbox"/>	3	3033073	Retaining Ring	1	
<input type="checkbox"/>	4	3055069	Threaded Plug	1	1 - 18 UNS.

<input type="checkbox"/>	5	3401290	Oil Pan Gasket	1	
<input type="checkbox"/>	6	3883036	Lubricating Oil Transfer Tube	1	
<input type="checkbox"/>	7	3896724	Hexagon Flange Head Cap Screw	32	M10 x 1.50 x 30
<input type="checkbox"/>		4059956	Pan , Oil Top Level Assembly	1	
<input type="checkbox"/>	1	67946	Plain Washer	2	1 1/32 in.
<input type="checkbox"/>	8	3008468	Pipe Plug	1	1/2 NPT.
<input type="checkbox"/>	9	3008470	Pipe Plug	1	1 NPT.
<input type="checkbox"/>		3055069	Threaded Plug	2	1 - 18 UNS.
		4059955	Oil Pan	1	
<input type="checkbox"/>	10	3070764	Lubricating Oil Suction Tube	1	
	11	4059954	Oil Pan	1	
<input type="checkbox"/>	12	3900630	Hexagon Flange Head Cap Screw	3	M8 X 1.25 X 20
		4952187		1	